

Assembling Angled Cabinetry

FITTING BLUM HINGES

The hinges fit into a 35mm diameter hole and two smaller holes keep the hinge square to the door. Usually we supply Blum INSERTA variants which use 8mm diameter lugs and a locking flap to give a tool-free fit.

The hinge is offered up to the door and then the flap is closed to lock the hinge in position. No screws are required.

NB ensure the hinge fits flush before closing the flap.



FORTSCHRITT
BESPOKE CABINETS SYSTEM

Assembling Angled Cabinetry

Occasionally INSERTA variants are not available in a particular hinge style in which case the hinge is secured with two 3mm diameter screws.

ADJUSTING BLUM HINGES

The Blum hinges we use have several adjustment points.

Adjustment from factory settings is usually not necessary but if needed it should be done at the final stages of installation.

Instances where adjustment may be required include:

- fine tuning door position in a run of cabinets to get the right optics e.g. one cabinet may not be exactly level but the door positioning can be adjusted so the installation looks right
- fine tuning door forward/backward position to get the right door travel when using push to open (TIP ON) actuators.
- when you want to alter the door reveals. We plan for a standard reveal of 2.5mm all round a door/drawer face

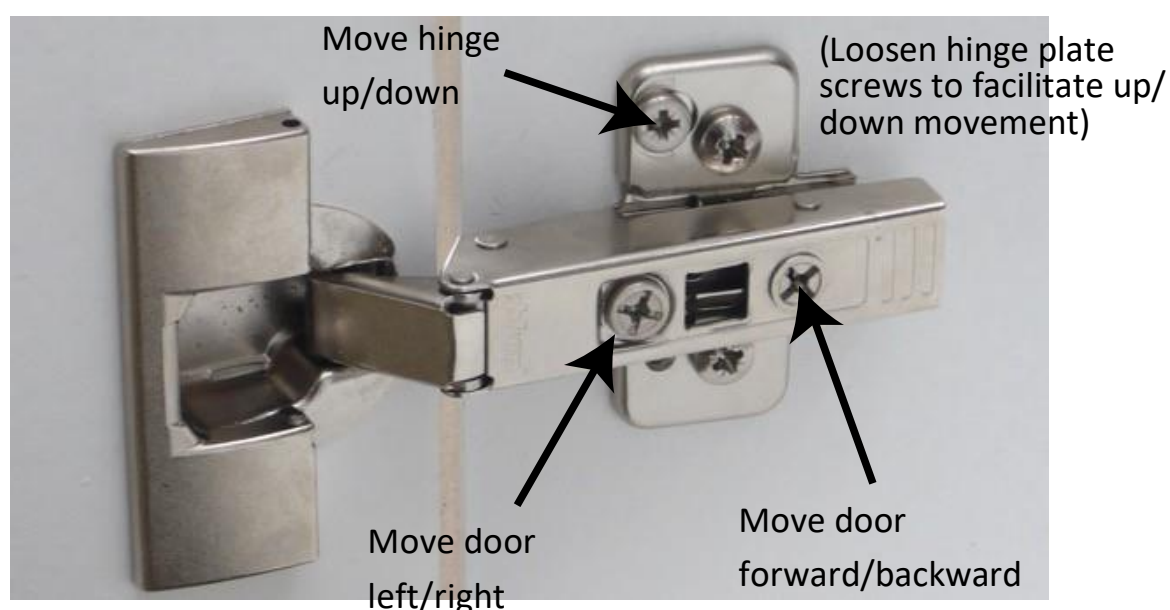

FORTSCHRITT
BESPOKE CABINETS SYSTEM

Assembling Angled Cabinetry

Moving door up/down

Use the cam screw on the hinge plate. You may need to loosen the hinge plate attachment screws to allow movement.

Moving door back/forth

Use the screw furthest from the front on the hinge arm. With TIP-ON push to open actuators the door needs to have around 2mm of travel to ensure the actuator triggers and resets.

Moving door left/right

Use the screw nearest the front on the hinge arm. With pairs of doors this adjustment screw can be used to ensure there is an even gap between the two doors. Our standard gap is 5mm although this can be overridden in the Cabinet Designer. NB with wide angle hinges (155 degrees and greater) this adjustment screw is accessed through a window in the outer part of the hinge arm.

Notes on adjusting hinges

Hinge adjustments should be made in quarter screw turns. This is because while adjusting one hinge the other hinges will resist door movement. Therefore make small adjustments to each hinge in turn and repeat as necessary.



FORTSCHRITT
BESPOKE CABINETS SYSTEM