

ASSEMBLING DRAWER BOXES WITH BLUM MOVENTO DRAWER RUNNERS

ASSEMBLING DRAWER BOXES WITH BLUM MOVENTO DRAWER RUNNERS

We aim for an end result with no visible fixings and where the drawer runner is not visible.



The system comprises:

- Blum Movento drawer runner attached to the cabinet sides using 5mm diameter 'Varianta screws
- A drawer box made up of a 'drawer underside', 'drawer box side left/right', 'drawer box back' and a 'drawer box front'. The drilling on the drawer box side left/right is identical so the names left/right can be interchanged on the panel label
- The drawer box is assembled and then sits on top of the drawer runner. The drawer box is held in place by the drawer runner prong at the back and an orange clip at the front secured to the drawer underside
- The drawer face attaches to the drawer box using drawer face adjuster fittings. The face adjuster allows the drawer face to be fine adjusted independently of the drawer box



Note on drawer box design

We have various designs of drawer box according to the materials used but the fitting principle is the same. Where we use 18mm thick material we need to route rebates where the drawer box sides meet the drawer runner as can be seen in the photos here. For 12mm thick Birch Ply, as shown on the left, we don't need to route the rebates



FORTSCHRITT
BESPOKE CABINETRY SYSTEM

ASSEMBLING DRAWER BOXES WITH BLUM MOVENTO DRAWER RUNNERS

BUILDING THE DRAWER BOXES

The drawer boxes sides are attached to the drawer box front/back using Minifix fittings:

- The Minifix bolt is screwed into the 5mm diameter holes in the drawer box sides
- The 8mm diameter holes in the ends of the drawer box front/back panels are lowered onto the Minifix bolts
- The 15mm diameter Minifix cam is fastened onto the Minifix bolt
- Ensure the Minifix cams are on the outside of the drawer box so that the fixings are not visible when the drawer is in place

Assemble drawer box sides, back/front



FORTSCHRITT
BESPOKE CABINETS SYSTEM

ASSEMBLING DRAWER BOXES WITH BLUM MOVENTO DRAWER RUNNERS

Attach drawer underside

The drawer underside is attached using 30mm long pan head screws. Offer up the drawer underside to the drawer box sides/front/back assembly. The drawer underside fits between the drawer box sides and the sides are proud by 6mm. This forms a ledge where the Blum Movento drawer runner will sit. The drawer underside is flush with the drawer box front/back. Ensure the 5mm hole in the edge of the drawer underside is at the back of the drawer box. The prong of the Movento drawer runner will locate in this hole.

Pilot hole positions are pre-drilled and use a 3mm diameter to drill through this position into the drawer box back/front. Use the 30mm long pan head screw to secure the drawer underside. The pan head screws ensure the edge of the drawer underside is not crushed.

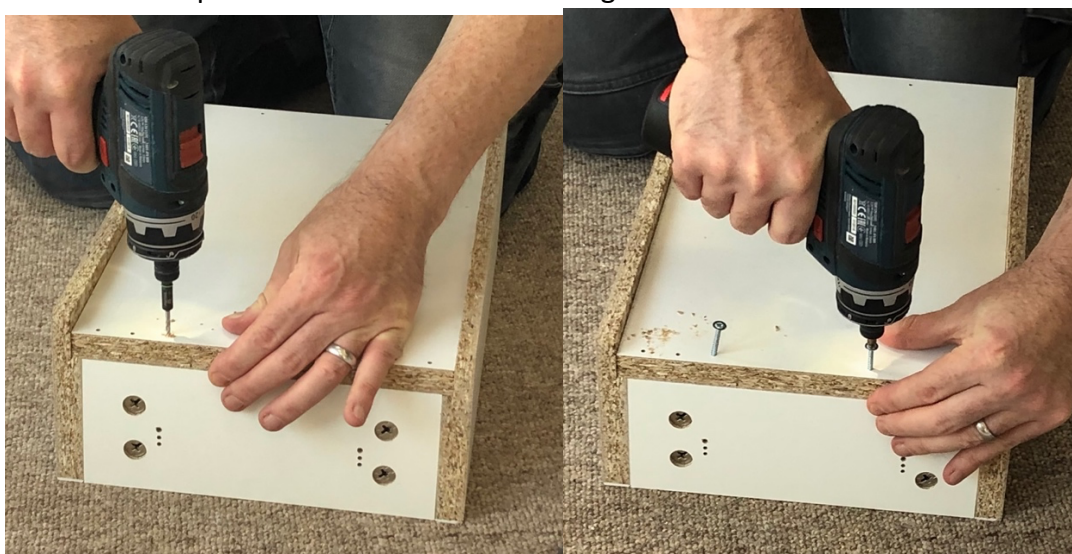

Attach Orange clip to front of drawer box

The rear of the drawer box locates onto the prong on the Movento drawer runner and the front is held in place with orange clips.



ASSEMBLING DRAWER BOXES WITH BLUM MOVENTO DRAWER RUNNERS



Usually the orange clips fits flush with the front of the drawer box. However if we have customised the drawer box depth to maximise beyond the 50mm depth Blum increments then the orange clip could be up to 50mm away from the front of the drawer box. You can check by offering up the drawer runner, ensuring the prong located in the hole at the back and clip the orange clip in.

Attach drawer runners to cabinet

The drawer runners attach using 5mm diameter 'Varianta screws'. Convention with Blum Movento is to start with the fourth screw hole from the front of the runner on the top row and align it with the pre-drilled hole on the cabinet side panel. The runners can be attached before or after the cabinet is assembled.



FORTSCHRITT
BESPOKE CABINETRY SYSTEM

ASSEMBLING DRAWER BOXES WITH BLUM MOVENTO DRAWER RUNNERS

ATTACH DRAWERS TO DRAWER RUNNERS

The drawer boxes sit on top of the runners with the runners locating between the two drawer box sides.

Slide the drawer box back until the prong of the drawer runner locates into the pre-drilled hole in the drawer underside and then the front of the runner will clip into the orange clip. Test the drawer operates.

Below is shown a photo of the rear of a drawer cabinet (back panel removed)



ATTACHING DRAWER FACES

The drawer face is separate to the drawer box and attaches by means of two 20mm diameter nylon 'drawer face adjuster' fittings.

These knock in into the pre-drilled holes in back of the drawer face and provide 2mm of adjustment up/down, left/right.

The drawer box front has two 3mm diameter holes pre-drilled. Use a 5mm diameter drill bit to bore out these holes to full depth and then connect the drawer box front to the drawer face adjuster using an M4 screw. Position the drawer face exactly and then tighten the M4 screws.